

ASSEMBLY INSTRUCTIONS

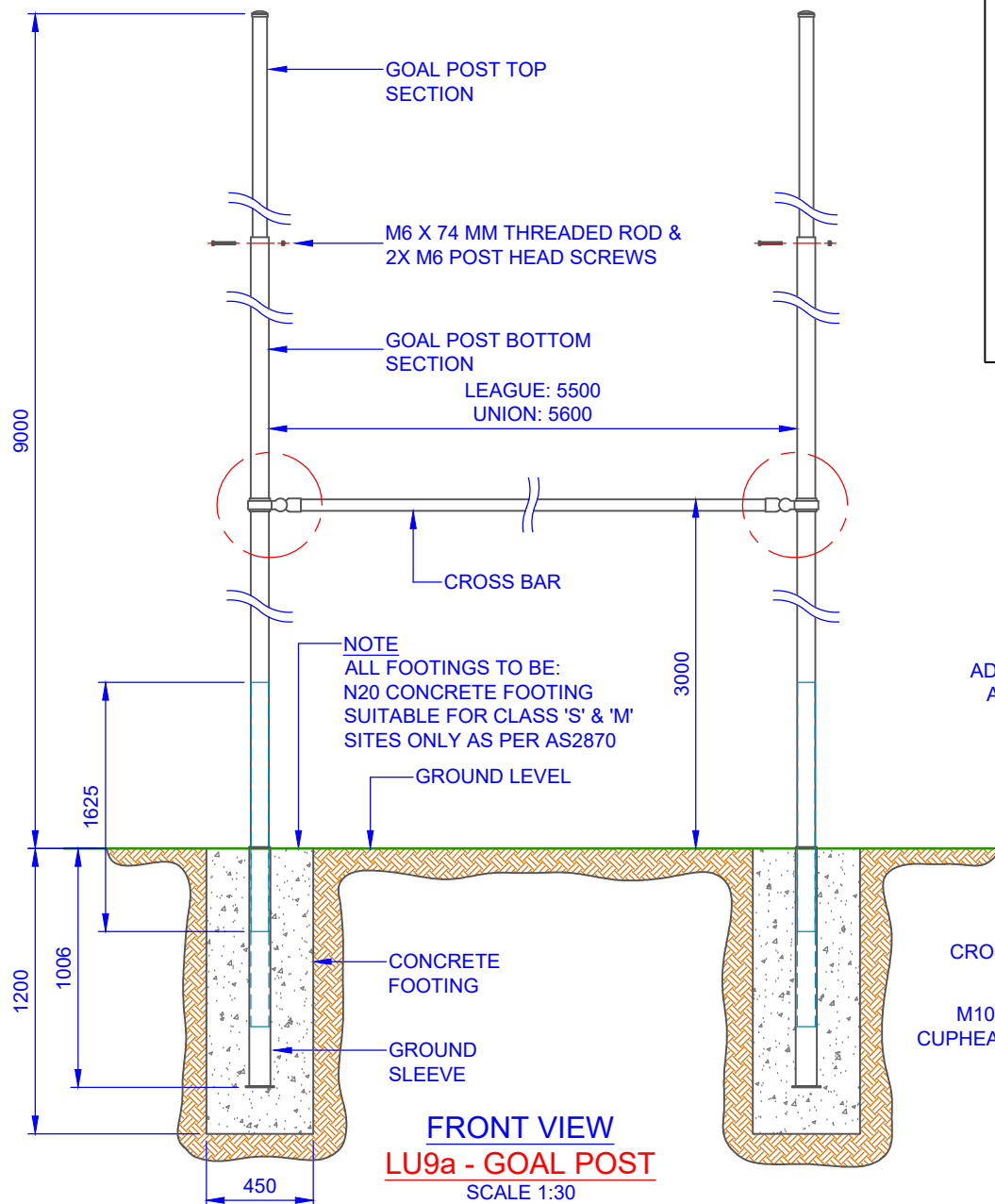

ASSEMBLY INSTRUCTIONS:

1. MARK THE POSITION OF THE HOLES FOR FOOTING. USE THE RUGBY PITCH CENTRE AS A REFERENCE LINE TO ENSURE THE POSTS ARE CENTERED.
2. CORE DRILL 450 MM DIAMETER, 1200 MM DEEP HOLES.
3. THEN POSITION THE GROUND SLEEVE CENTERED TO THE HOLE AND POUR THE CONCRETE.
4. THE CONCRETE SPECIFIED IS FOR 'S' AND 'M' SOIL ONLY. PLAY HARD SPORTS MUST BE NOTIFIED OF ANY OTHER SOIL CONDITION. THIS WILL INCUR ADDITIONAL CHARGES FOR RE-ENGINEERING THE FOOTINGS.
5. LET THE CONCRETE SET FOR 2-3 DAYS.
6. ONCE THE CONCRETE IS SET, ASSEMBLE THE GOAL POST TOP AND BOTTOM SECTION USING M6 X 74MM THREADED ROD & 2 X POST HEAD SCREWS.
7. INSERT THE POST INTO THE GROUND SLEEVE.
8. ATTACH THE CROSS BAR TO THE POSTS USING CROSSBAR CLAMP.

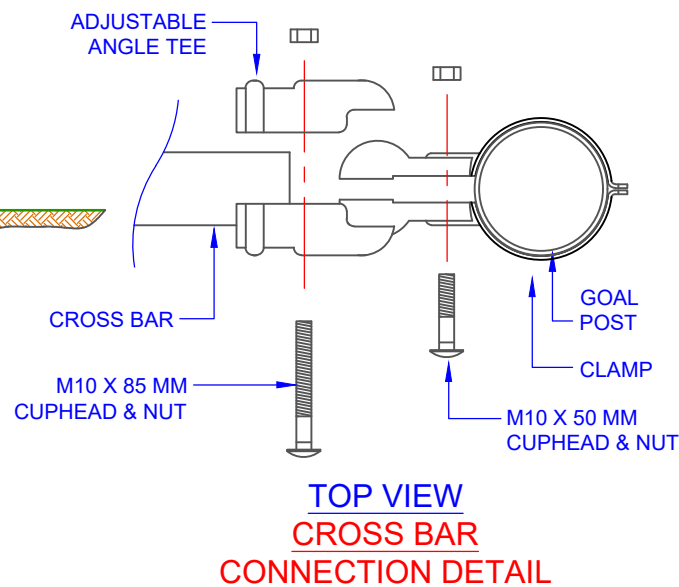

TITLE: LU9a RUGBY GOAL POSTS
 ASSEMBLY DETAIL 2 OF 2
 FOOTING PLAN

DRAWING NUMBER:
 LU9a RUGBY GOAL POSTS



Oz Ring Pty Ltd

Trading as:

Play Hard Sports Equipment

ABN 79 066 094 559

24 Ern Harley Drive

Burleigh Heads Qld 4220

Phone: (07) 5593 4494

Fax: (07) 5593 4338

Website: www.playhardsports.com.au

Email: email@playhardsports.com.au